

USER MANUAL

INFINITY SEASCOOTER (PRO)

(UK)

THIS MANUAL MUST BE READ BEFORE USING THIS PRODUCT
SAVE THIS OWNER'S MANUAL! KEEP FOR FUTURE REFERENCE

(FR)

CE MANUEL DOIT ETRE LU AVANT D'UTILISER CE PRODUIT
GARDER LE EN REFERENCE

(ES)

ESTE MANUAL DEBE LEERSE ANTES DE USAR EL PRODUCTO
GUARDAR ESTE MANUAL! TENERLO PARA FUTURAS CONSULTAS.

(DE)

DIESE BEDIENUNGSANLEITUNG MUSS VOR DER VERWENDUNG DIESES PRODUKTS DURCHGELESEN WERDEN

HEBEN SIE DIESE BEDIENUNGSANLEITUNG FÜR ZUKÜNFTIGE FRAGEN AUF

(GR)

ΑΥΤΟ ΤΟ ΕΓΧΕΙΡΙΔΙΟ ΠΡΕΠΕΙ ΝΑ ΔΙΑΒΑΣΤΕΙ ΠΡΙΝ ΑΠΟ ΤΗ ΧΡΗΣΗ ΤΟΥ ΠΡΟΪΟΝΤΟΣ
ΦΥΛΑΞΤΕ ΤΟ ΕΓΧΕΙΡΙΔΙΟ ΧΡΗΣΗΣ! ΚΡΑΤΗΣΤΕ ΓΙΑ ΜΕΛΛΟΝΤΙΚΗ ΑΝΑΦΟΡΑ

(IT)

QUESTO MANUALE DEVE ESSERE LETTO PRIMA DI UTILIZZARE IL PRODOTTO
SAVE THIS OWNER'S MANUAL! KEEP FOR FUTURE REFERENCE

(PT)

ESTE MANUAL DEVE SER LIDO ANTES DE USAR ESTE PRODUTO
GUARDE ESTE MANUAL DO PROPRIETÁRIO! GUARDE-O PARA REFERÊNCIA FUTURA

(SE)

DENNA BRUKSANVISNING MÅSTE LÄSAS INNAN DU ANVÄNDER DENNA PRODUKT
SPARA DEN HÄR BRUKSANVISNINGEN! SPARA FÖR FRAMTIDA REFERENS



14+



WEIGHT
7LBS/3,2KG



DEPTH
99FT/30M



GEAR
3 SPEED



MANUFACTURED BY:
Jobe Sports International
Heerewaardensestraat 30,
6624 KK Heerewaarden
The Netherlands

tel. +31(0) 487 573090
e-mail: info@jobesports.com
url: www.jobesports.com



JOBE

THANK YOU FOR CHOOSING OUR INFINITY SEACOOTER!
Before operating the Infinity Seacooter, read this User's Guide for the proper instruction on use and care of the Infinity Seacooter!

 <p>The lightning flash and arrow head within the triangle is warning sign alerting you of dangerous voltage inside the product.</p>	<p style="text-align: center;">CAUTION</p> <p style="text-align: center;">RISK OF ELECTRIC SHOCK DO NOT OPEN</p> <p style="text-align: center;">CAUTION: TO REDUCE THE RISK OF ELECTRIC SHOCK DO NOT REMOVE COVER (OR BACK). NO USER-SERVICEABLE PARTS INSIDE. REFER SERVICING TO QUALIFIED SERVICE PERSONNEL.</p>	 <p>The exclamation point within the triangle is a warning sign alerting you of important instructions accompanying the product.</p>
---	---	---

⚠ WARNING

- Do not forget to soak the Infinity Scooter in freshwater for few minutes immediate after use.
- Always rinse the Infinity Scooter in fresh water and dry it before storage.
- Do not use detergents, only use a damp cloth to wipe the unit clean.
- If salt water has entered, rinse battery pack with fresh water and dry it.
- Keep downward direction when you are changing battery pack.
- Pls keep dry for the connectors.
- Before installing battery, always check if black rubber sealing is in place and locked in the right position.
- If not water will enter the connection and cause a short circuit. This is not covered
- Keep 1 meter distance from other persons.
- Do not use the seacooter if there are cracks or tears in the housing.
- Store the battery separately from the seacooter
- Jobe recommends to store the battery in a Safety box, especially when stored on yachts, cars etc



Don't touch the propellor guard when in use or when battery is installed.



Pls wear a swimming cap, Particular care should be exercised while using with open hair.



Keep downward direction when you are changing battery pack.



The battery connector must be kept dry at all times.



Check whether the screw is present in the housing.

Please soak the Infinity Seacooter into freshwater several minutes after use.

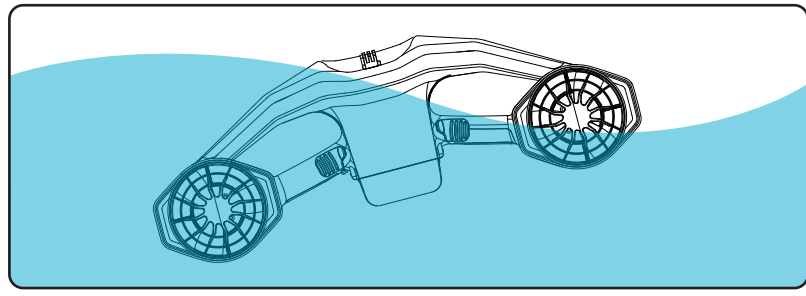

Rinse the battery and battery connectors with fresh water. Make sure the connectors are clean and dry before charging and next usage.

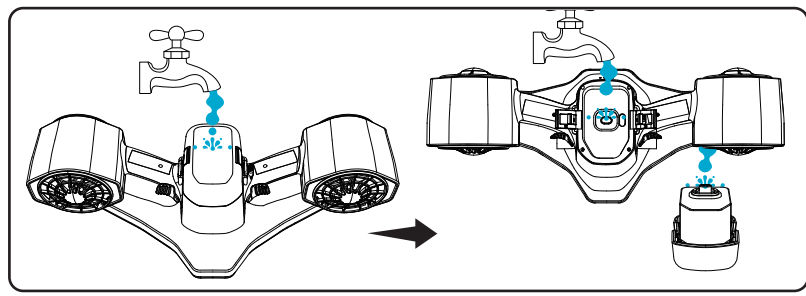

Pack battery and Infinity Seacooter separately when boarding an airplane. ⚠ Check your airline's regulations to see if batteries are allowed on the plane





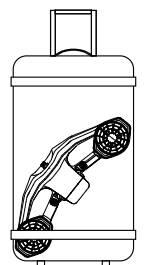

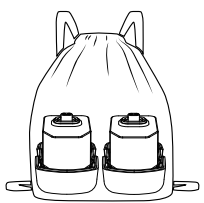

Carry the batteries in your hand luggage.
This may differ per airline, check the regulations of your airline.

Before You Begin

Before learning to use your Infinity Scooter, You must read this user manual to follow all instructions and warnings. It is important that you follow all safety warnings and cautions that appear throughout the user manual and that you use good judgment when you use your Infinity Scooter.

The Risk of injury

For safety purpose always wear a Approved- PFD (Personal Flotation Device) while snorkeling.

Always inspect the swimming area to ensure it is free of hazards or obstacles such as boats and swimmers before using the Infinity Scooter. When using the Infinity Scooter for scuba, ascents and descents should be made in accordance with recognized diving practices.

Disposal and Storage

Disposal of according to local laws. Always keep the Infinity Scooter out of direct sunlight when not in use. Heat kills batteries.

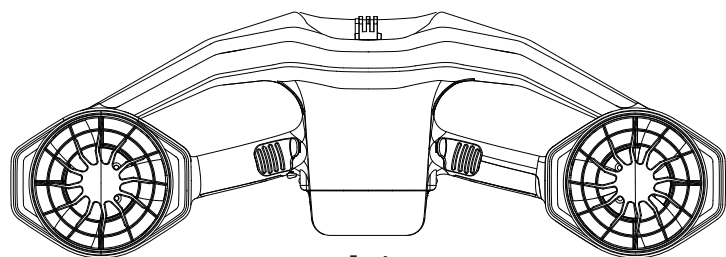

Front

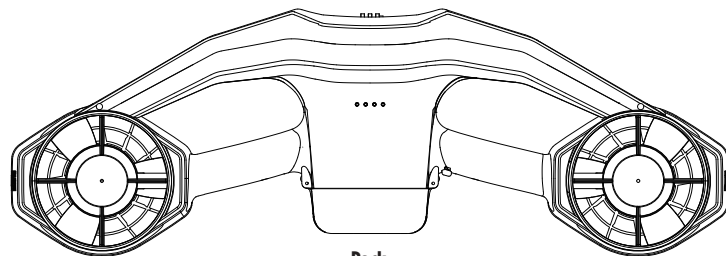

Back

Main Components

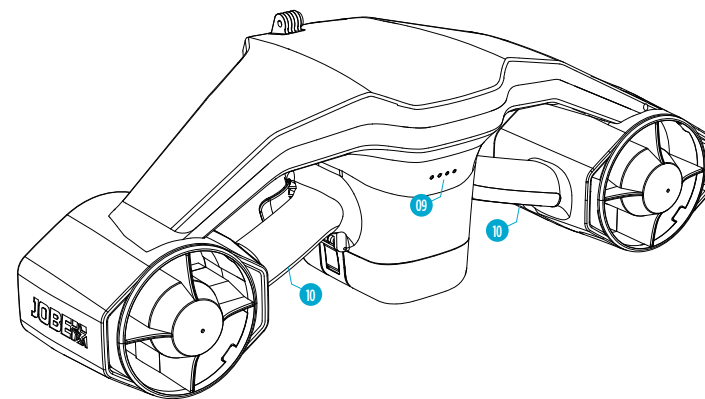
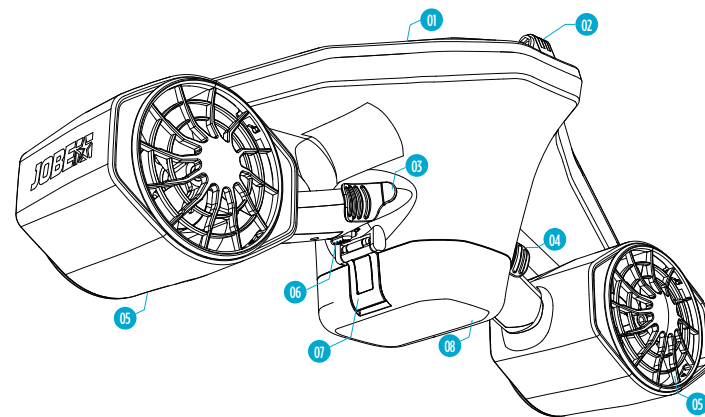

- 01 Buoyancy tank
- 02 Sports camera holder
- 03 Right switch / Acceleration switch
- 04 Left switch / Deceleration switch
- 05 Motor / Propeller
- 06 Switch locker
- 07 Battery pack locker
- 08 Battery pack
- 09 LED indicators
- 10 Handle

Install & Uninstall the Battery Pack

1. Put the battery pack into the body

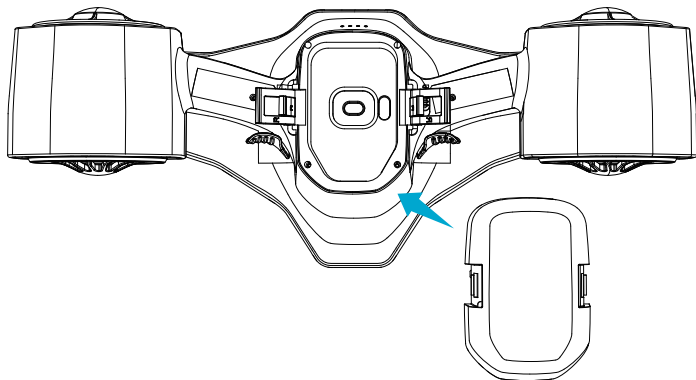

2. Fix the inner buckle of the battery pack

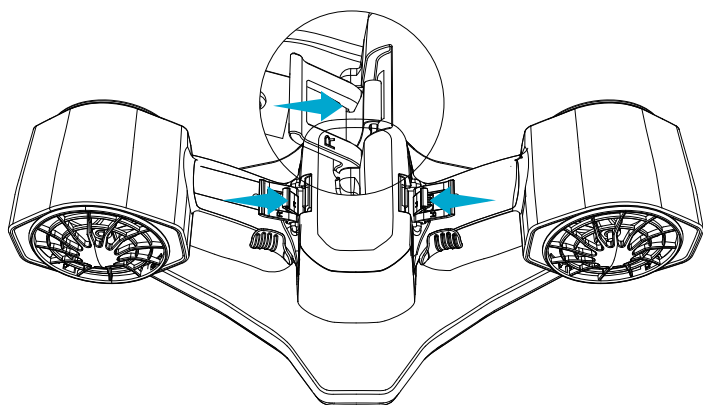

3. Battery will adjust according to its space and fit in.

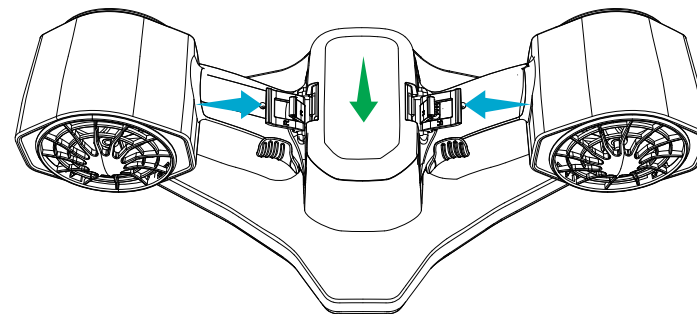

4. The battery pack is installed well



The covers of propeller is detachable design

- Align the propeller and grilles cap, rotate it clockwise adjust until fitting sound occur.

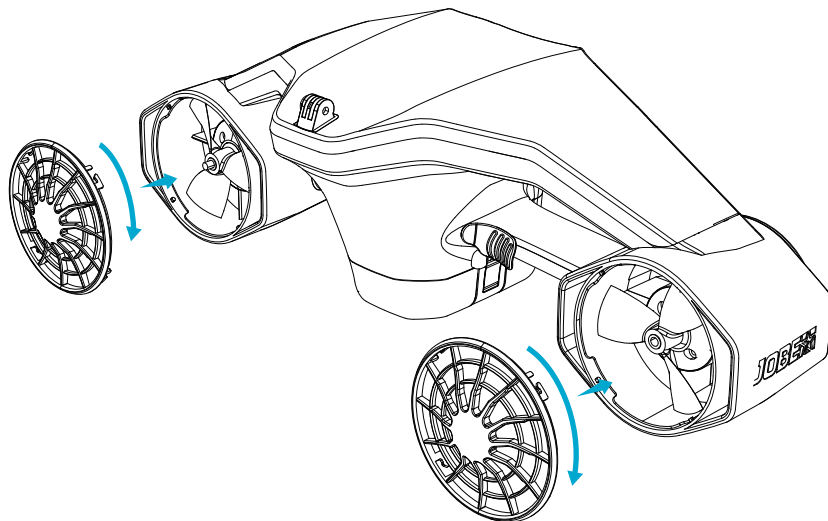

How to use

- Place the Infinity Seascooter into the water. When ready to set off, unlock the Switch first, press and hold both Triggers to start the propeller. To stop the propeller, simply release the Trigger. Always lock the Switch off when out of the water.

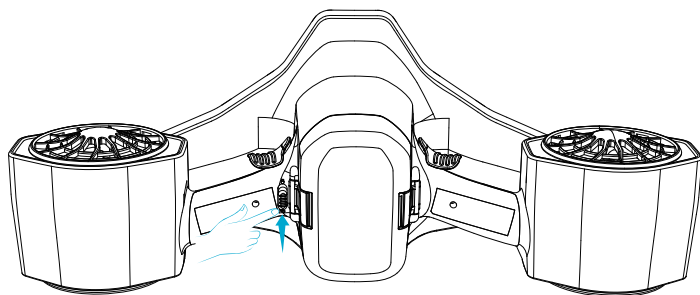

- There are 3 speed modes of the Infinity Seascooter, always start from 1st level of speed mode and increase according to convenience.

- Hold the Left Trigger and press Right Trigger twice to increase the speed.
Hold the Right Trigger and press Left Trigger twice to decrease the speed.
- Proper posture when using the Infinity Scooter is important to achieve the maximum speed-see figure for the correct position of the Infinity Scooter.

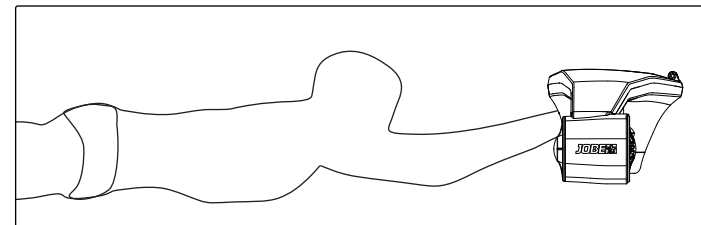

CAUTION

Do not dive deeper than you would normally when snorkeling, to ensure you can get back to the surface safely.

Charge Battery Pack (for EL-SS02 / EL-SS02S)



CAUTION:

- The battery pack can not be charged as the temperature is over 48°C (118°F), as the temperature drop down, then start to charge.
- Don't leave the battery unsupervised when charging
- Be present when charging the battery
- Store and charge in a dry and well ventilated room
- Jobe recommends to store the battery in a Safety box, especially when stored on yachts, cars etc

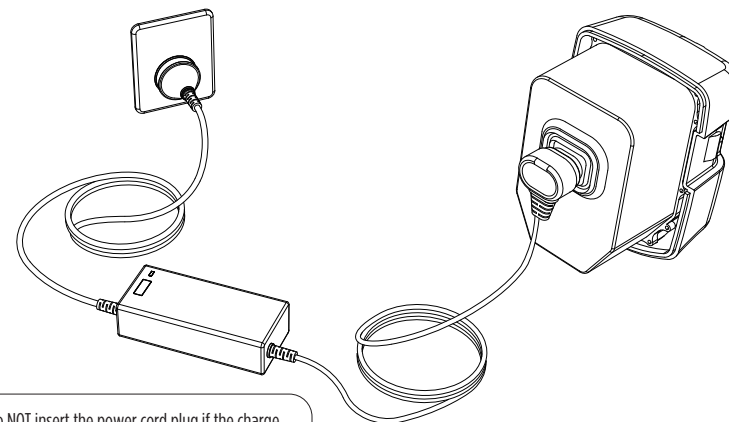

Do NOT insert the power cord plug if the charge port, power cord or AC power outlet is wet.

Lights during use:

- ● ● ● High level of charge
- ● ● ○ Medium level of charge
- ● ○ ○ Low level of charge
- ✳ ○ ○ ○ Empty, needs charging

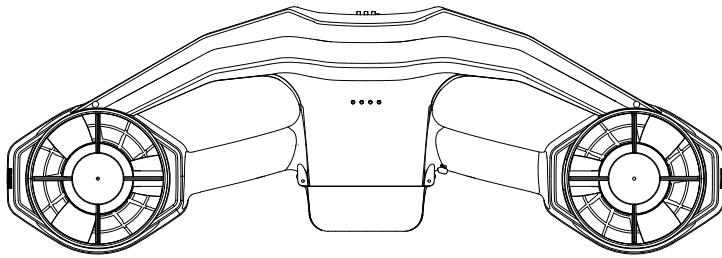

✳ 1 quick flashing light indicates below 20% of battery level, needs to charge.

Caution: Normally, the battery will be warm after use with 3rd gear

Contents

- Infinity Seascooter x1
- Battery Pack x2
- AC Charger x1
- Carry Bag x1
- Snorkel set x1
- User Manual x1

Technical Specifications

Model:	EL-SS02 Seascooter	Run time:	-38 minutes
Input:	DC 29.4V / 2A	Charging time:	3,5 hours
Capacity:	5000mAh / 126Wh / 25.2V	Environment:	-10°C - 40°C
Max. speed:	1.5 m/s	Net Weight:	7.0 lbs / 3.2kg (without battery pack)
Max. depth:	99 ft / 30 m	Size:	581 x 236 x 200 mm

Model:	EL-SS02S Seascooter Pro	Run time:	-40 minutes
Input:	DC 29.4V / 2A	Charging time:	5 hours
Capacity:	8000mAh / 201.6Wh / 25.2V	Environment:	-10°C - 40°C
Max. speed:	2.5 m/s	Net Weight:	7.0 lbs / 3.2kg (without battery pack)
Max. depth:	99 ft / 30 m	Size:	581 x 236 x 200 mm

We certify that the power supply is used as a device for disconnecting the power distribution network, which should stay easily accessible.

Running time

Speed mode Infinity Seascooter	Run time (per battery):	max. Thrust
Gear 1 (slow):	-38 minutes	5.96 kg
Gear 2 (middle):	24 minutes + 3 minutes safety mode (gear 1)	9.02 kg
Gear 3 (fast):	12 minutes + 3 minutes safety mode (gear 1)	12.02 kg

Speed mode Infinity Seascooter Pro	Run time (per battery):	max. Thrust
Gear 1 (slow):	-40 minutes	7.2 kg
Gear 2 (middle):	22 minutes + 7 minutes safety mode (gear 1)	12.13 kg
Gear 3 (fast):	11 minutes + 7 minutes safety mode (gear 1)	15.06 kg

*Indicated runtime is maximum and depends on several factors.

*Tested with a 70kg user.

FAQ:

- Is the Infinity Seascooter sinking into the water?

A No, it will float slightly on the water.

- Can I replace the battery underwater or put battery pack into water?

A No, it's not Safe. The connector of battery pack and main board will break.

- Is the Infinity Seascooter waterproof?

A Yes, The battery, motor and main board connectors are waterproof. Water will enter inside the body while using it.

- Why need soak and rinse the Infinity Seascooter with fresh water after use?

A Seawater contains salt crystals, sand particles and Swimming pool have chlorine/acids that can cause of corrosion. So it is necessary to rinse it with Fresh Water within few minutes after the dive. The longer you delay to remove materials that cause potential corrosion the more damage can be done.

- Why should the battery and Infinity Seascooter be kept dry?

A Make sure the battery and main boards connectors are completely dry before storage, otherwise it will be damage due to oxidation in electrolysis after power-on.

- Why does the motor can not work after power-on some time?

A It may be the sand particles or crystals in the motor compartment. Please put the machine into the water for few minutes and then start the machine continuously until the motor works normally.

- Can I use the battery pack if the case was broken ?

A No, We suggest you to contact your local dealer to replace the battery pack.

- Is the Infinity Seascooter failure if four battery indicator light are flashing at the same time?

A Yes, the Infinity Seascooter has a self-healing function. It will work again, just release the switch and wait for the light indicator to go out.

- Will the speed decrease as the power is decremented?

A No, Speed will remain same until the power off.

- Why does the battery can not be charged after plug it?

A The battery pack may be heat after use , so it can not be charged immediately. As the temperature drop down, then start to charge.

- Can I bring it by plane?

A Rules for travelling with lithium batteries can differ per airline and country. Please check your airline's specific guidelines before you fly to make sure you can bring your seascooter battery safely.

MANUEL DE L'UTILISATEUR *INFINITY SEASCOOTER (PRO)*



FABRIQUÉ PAR:
Jobe Sports International
Heerewaardensestraat 30,
6624 KK Heerewaarden
The Netherlands

tel. +31 (0) 487 573090
e-mail: info@jobesports.com
url: www.jobesports.com



JOBE 